

SIDE AWNING

CALYPSO ROLL

Standard features and important information

- Cassette with 2 wall brackets.
Pull profile with a handle in the frame colour, 2 wood types or stainless steel (additional charge) available.
Optionally pole 1, pole 2 or wall bracket included in basic price. Flexible pole up to max. projection 400 cm available at additional charge.
- Fixing materials not included in delivery.
- Please note that the vertical position of the fabric may result in slight sagging of the fabric edges.
- Side awnings can only be used as a wind guard if combined with the WPS system (up to wind strength 5/wind class 2). Without WPS system: wind class 0.
- For information about wind strengths, see page 7 (without WPS system wind class 0).
- Multicolour stripes in acrylic, polyester: TEMPOTESTSTAR LIGHT and GROOVE always run vertically. PRECONSTRAINT 302 block stripe designs run horizontally.
- Fabric height = cassette size -10 cm (for SOLTIS -13 cm)
- The roller at the pull rod serves as an aid to removal (cannot be combined with flexible pole). It can only be used as an aid to retraction if the substrate is not inclined.
- From defined sizes the systems in acrylic, polyester: TEMPOTESTSTAR LIGHT and GROOVE, PRECONSTRAINT or SOLTIS are fitted with stiffeners.

Frame colour options

Powder coating white aluminium	RAL 9006
Powder coating pure white	RAL 9010
LEINER LOUNGE dark grey	

Special colours

All other RAL colours: additional charge, see price section
All other LEINER LOUNGE colours: additional charge, see price section

All other colours (e.g. NCS): additional charge, feasibility and delivery period on request

Drawings and mounting tips for CALYPSO ROLL

Cassette fixing

Cassette with wall bracket (standard)

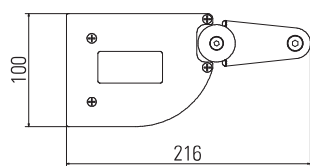

Wall bracket

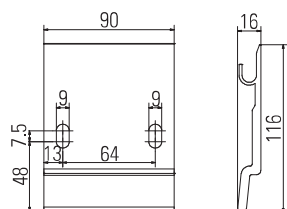

Cassette with soffit fitting for wall bracket

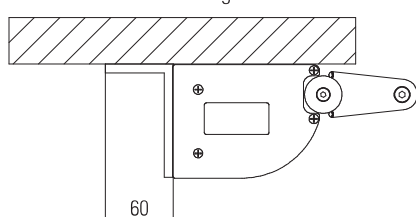

Soffit fitting with wall bracket

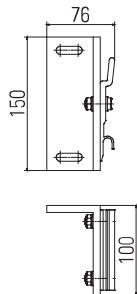

Soffit fitting for wall bracket

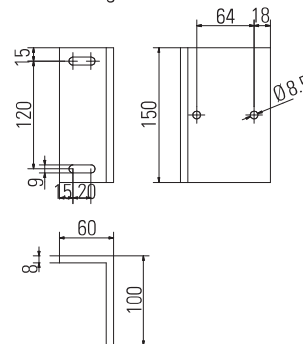

Pull profile fixing

Top view of pole 1 / pole 2 (standard)

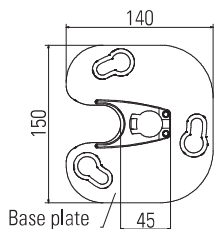

Wall fixtures

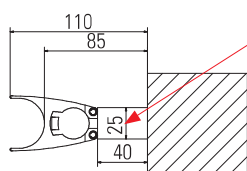

Wall fixture with soffit fitting

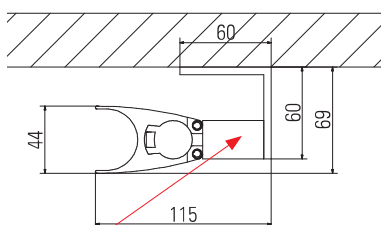

Flexible pole

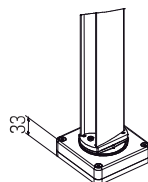

Soffit fitting for wall fixture

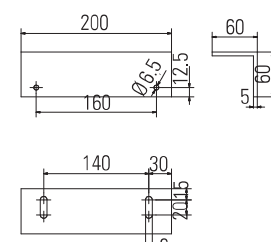

Top view of flexible pole

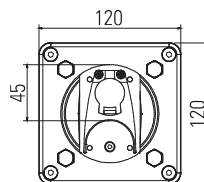

Top view of U72

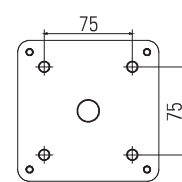

Wall mounting block

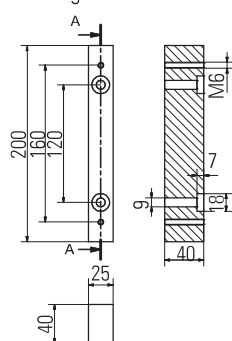

SIDE VIEW AND SIZE CONSTRAINTS

CALYPSO ROLL

CALYPSO ROLL

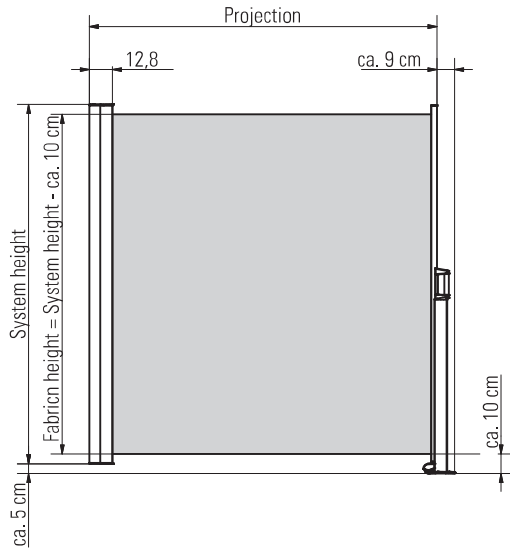

CALYPSO ROLL ASYMMETRIC SYSTEM

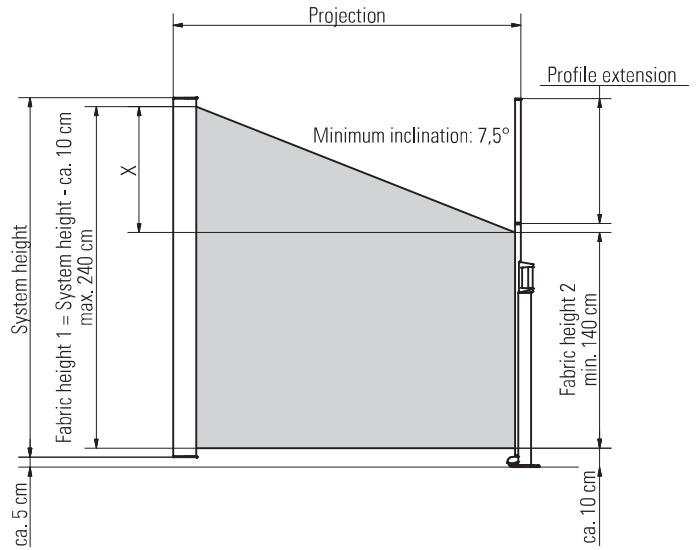

Minimum inclination:

Projection	200 cm	250 cm	300 cm	350 cm	400 cm
X	26 cm	33 cm	39 cm	46 cm	52 cm

CALYPSO ROLL with window

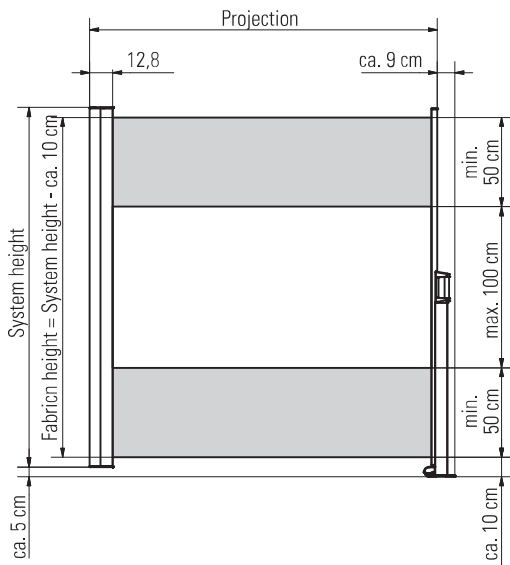

CALYPSO ROLL ASYMMETRIC SYSTEM with window

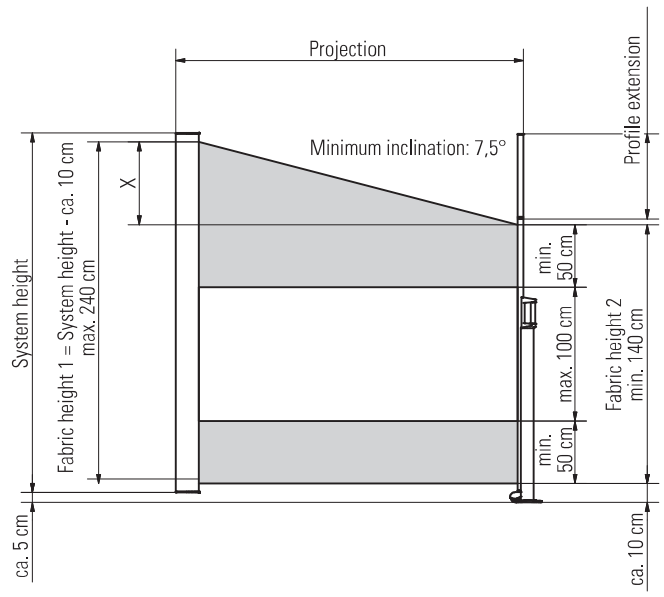

Minimum inclination:

Projection	200 cm	250 cm	300 cm	350 cm	400 cm
X	26 cm	33 cm	39 cm	46 cm	52 cm

Important ordering information

For asymmetric systems and systems with a window, always indicate whether a right or left version is wanted.

View from above

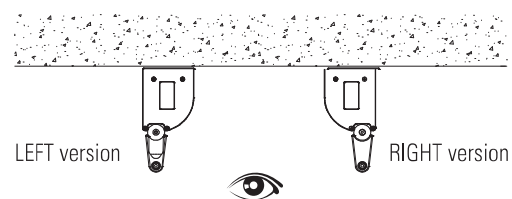

2018 selling prices

Recommended retail price in € exclusive of VAT
Valid from 01.04.2018 • Subject to technical changes